

GENERAL HIGHWAY MAP WHEELER COUNTY NEBRASKA

PREPARED BY THE
DEPARTMENT OF ROADS
GIS/MAPPING SECTION
IN COOPERATION WITH THE

U.S. DEPARTMENT OF TRANSPORTATION
FEDERAL HIGHWAY ADMINISTRATION

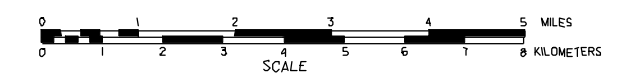

INVENTORY DATE:
2004

NAME	REVISION	REVISION
D. THORN	JAN. 2004	HIGHWAY SUPERINTENDENT
D. NELSON	JAN. 2005	COUNTY
L. COLDSMITH	NOV. 2007	311 SYSTEM

LEGEND

- | | | | |
|--|-------|---|-------|
| Primitive Road | | Filling Station | |
| Unimproved Road | | Grain Elevator | |
| Gravel or Crushed Rock | | Aggregated Pk. | |
| Asphalt Bituminous Surface | | Agricultural Experimental Station | |
| Multiple Lane Undivided Highway | | Educational Institutions | |
| Asphalt Bituminous Surf. Face | | Public Use Area | |
| Concrete/Brick Surf. Face | | Recreation Facilities | |
| Multiple Lane Divided Highway | | State Parks | |
| Corporate/Tron. Surf. Face | | Res. Area | |
| Divided Highway | | Ranger Station | |
| Interstate Highway with Full Control of Access | | Film Hatchery | |
| Slide Roads and Streets | | Community Hall | |
| 911 NAMED/NUMBERED ROADS | | Correctional Institution | |
| Interstate-Numbered Highway | | Tourist Court or Motel | |
| US-Numbered Highway | | Monument-Small | |
| State-Numbered Highway | | Museum | |
| State-Numbered Highway Spur | | Preservation | |
| State-Numbered Highway Link | | Courthouse | |
| Highway Reference Post Number | | Army | |
| Interstate Exit Number | | Post Office | |
| Mid Stream | | Highway Maintenance Yard | |
| Narrow Stream | | Dump Area | |
| Irrigation Ditch | | Sewage Disposal Plant | |
| Reservoir, Pond or Lake | | Water Supply Stand Pipe | |
| Reservoir, With Dam | | Road or Tr. Station | |
| Highway Bridge-Any Type | | Weight Station or Part of Entry | |
| Low Spaced | | Commercial or Municipal Airport | |
| Small Bridges-Closely Spaced | | Airport with Paved Runways | |
| Structure Spaced more than 100 ft. apart | | State Boundary | |
| General Bridge | | County Boundary | |
| Arch Bridge | | Township Line | |
| Truss Bridge | | Section Line | |
| Pedestrian Underpass | | Corporate Limit Lines | |
| Pedestrian Overpass | | Parks and Other Reservations | |
| Railroad Overpass | | Boundary Limits of Area Shown in Enlargements | |
| Railroad Underpass | | State Capital | |
| Railroad | | County Seat | |
| Dam with Road on Top | | Other Cities and Villages | |
| Coffee Guard | | Dwelling | |
| Dwelling | | Row of Dwellings | |
| Row of Dwellings | | Cemetery | |
| Cemetery | | Church or Other Religious Institution | |
| Church or Other Religious Institution | | Church with Cemetery Adjacent | |
| Church with Cemetery Adjacent | | Hospital | |
| Hospital | | Business | |
| Business | | Industrial Plant | |
| Industrial Plant | | Latitude and Longitude | |

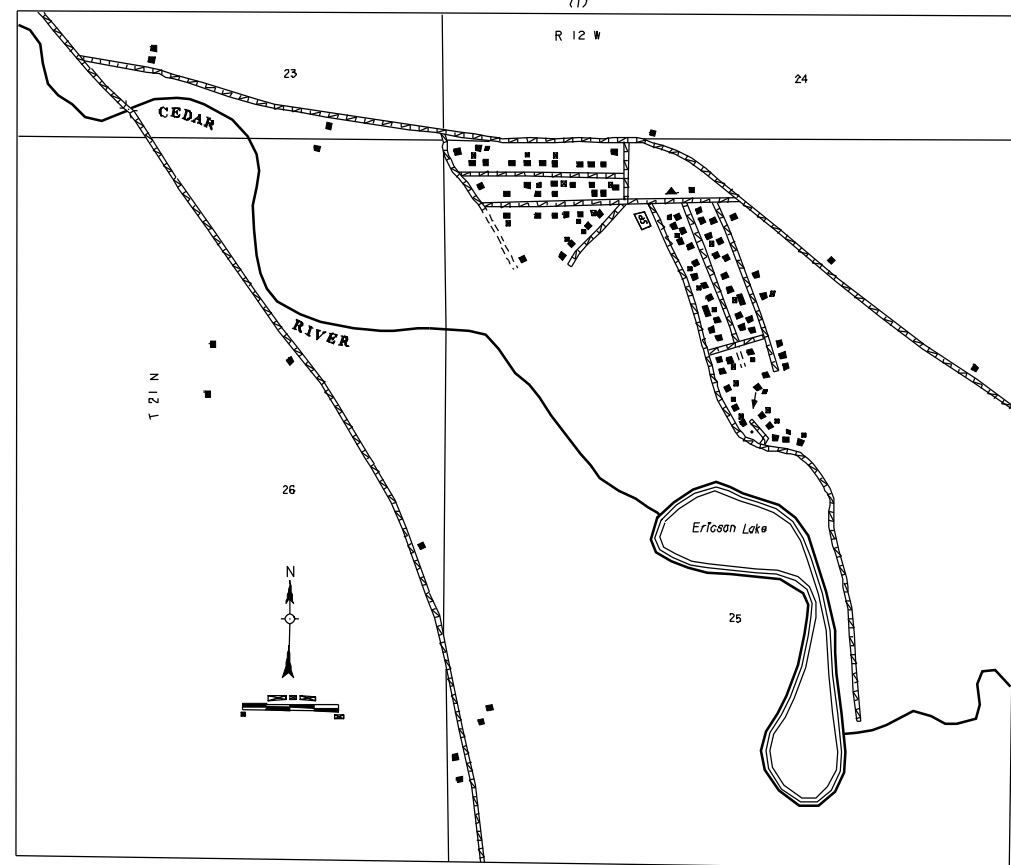

LEGEND

NATIONAL FUNCTIONAL CLASSIFICATION:

INTERSTATE.....

OTHER RURAL PRINCIPAL ARTERIALS.....

RURAL MINOR ARTERIALS.....

RURAL MAJOR COLLECTORS (STATE).....

RURAL MAJOR COLLECTORS (COUNTY).....

RURAL MINOR COLLECTORS.....

Revised April 25, 2001

All Roads Not Otherwise Indicated Are Classified Local.

